



2010-11 CAMARO  
STYLING KIT

# 3dCARBON™

## INSTALLATION INSTRUCTIONS

Rev. 04-11

QTY	3D PART NO.	DESCRIPTION
1	691800	FRONT AIR DAM
1	691802	RIGHT SIDE SKIRT
1	691801	LEFT SIDE SKIRT
1	691804	REAR LOWER SKIRT - RIGHT SIDE
1	691803	REAR LOWER SKIRT - LEFT SIDE
4	3M 94	3M ADHESION PROMOTER

### HARDWARE SUPPLIED

12	#8 X 3/4" SELF DRILLING SCREWS
26.5'	FEET 3M DOUBLE FACE TAPE
8	CRUZ CLIPS
8	1" PHILLIPS HEAD TRUSS SCREWS

### TOOLS & MATERIALS REQUIRED

- 1/4" Drive Socket Set
- Phillips Screw Tip
- 90 Degree Angle Screw Gun Attachment
- Christmas Tree Clip Puller
- Clean Wiping Cloths
- Air or Electric Drill Motor
- 1/8" Drill Bit & 1/4" Drill Bit
- Lacquer Thinner



**CAUTION!!!! IF A HEATED SPRAY BOOTH IS USED FOR BAKING THE PRIMER OR PAINT, DO NOT BAKE OR CURE GREATER THAN 120 F DEGREES FARENHEIT. THE PARTS CAN BE DISTORTED AND PERMANENTLY DAMAGED.**

**NOTE: These step by step installation instructions are for after the kit is painted. Please see the “Prepping and Painting” Instructions prior to prepping the parts for paint.**

### **PREPPING THE KIT PRIOR TO PAINT**

The first step is to inspect the parts to make sure you have the correct parts. Refer to the part numbers on the back of the parts to confirm the Year – Make – Model. Parts that are prepped and painted cannot be returned or exchanged.

Using lacquer thinner and a clean cloth – clean the tape flange surface on the back of each part where the double-sided tape will be applied. Using 1” masking tape, apply the tape 1/8” below the top edge of the part. This will protect the tape flange from getting contaminated during the prepping and painting process.

Refer to Prepping and Painting Instructions for “Step by Step” procedures.

### **APPLYING THE 3M TAPE TO THE KIT**

After the kit has been prepped and painted, the double face tape should be applied to the parts. The tape is not pre-installed on parts prior to shipping because the tape can be contaminated during the sanding/ priming and painting process.

The first step is to clean the tape flange on the back of the parts where the tape will be applied. Make sure the complete tape flange is clean and free of all primer and paint. Using lacquer thinner on a clean rag, thoroughly clean the tape flanges on all parts of the kit.

Using the adhesion promoter bottle with felt tip supplied, apply it to the tape flanges – be careful not press too hard causing too much to be applied. The adhesion promoter will leave a thin clear polymer primer film that will increase the bonding strength of the double face tape.

The tape should be applied 1/8” down from the top edge of the part so that it cannot be seen after the kit is installed. The tape is to be applied from the wheel well to the center. Press the tape firmly to the surface to ensure good adhesion. (See image)



Repeat the cleaning and adhesion promoter steps on all parts of the kit.

## FRONT BUMPER REPLACEMENT

HARDWARE SUPPLIED	
4	#8 X 3/4" SELF DRILLING SCREWS
4	CRUZ CLIPS
4	1" PHILLIPS HEAD TRUSS SCREWS
7.5'	3M TAPE

Step 1) Using a tape measure, measure 12 3/4" down from the corner of the fender to the bottom of the bumper. See images #1-2.



IMAGE #1



IMAGE #2

Step 2) Place the front air dam on the front factory bumper and check the fit. The front center section should fit flush inside the opening on the bumper. The top edge of the air dam should parallel the bodyline on the factory bumper. Using a grease pencil draw a line along the top edge of the part for reference during final installation. See image #3-4.



IMAGE #3



IMAGE #4

Step 3) Remove the part from the car using Lacquer Thinner on a clean lint free cloth wipe the paint surface where the tape will attach. Be careful not to remove the grease pencil marks. Using the adhesion promoter supplied, apply the adhesion promoter to the paint surface where the tape will attach. \*\*\*When applying the 3M tape, apply a double layer to the front of the front air dam to ensure good adhesion.

Step 4) Peel back a small piece of the red plastic backing from the tape making a tail that can be pulled when the air dam is installed. Place the air dam on the car, positioning it using the grease pencil marks previously made as a reference. Starting with the center section pull the red backing tail and press the air dam to the paint surface to insure good adhesion of the double face tape. See Images #5-6.



Step 5) Using the (4) supplied # 8 x 3/4" self-taping screws secure the air dam through the pre-drilled holes located on the bottom of the air dam, underneath of the car. See Image #7.

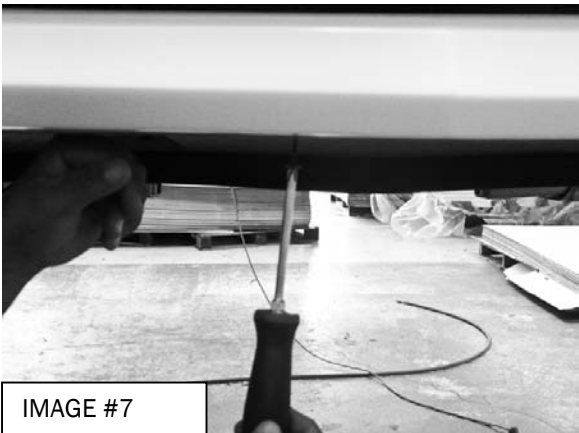

Step 6) Using the supplied (2) cruz clips and Phillips head screws, secure the air dam through the pre-drilled holes located in the wheel well. See Images #8-9.

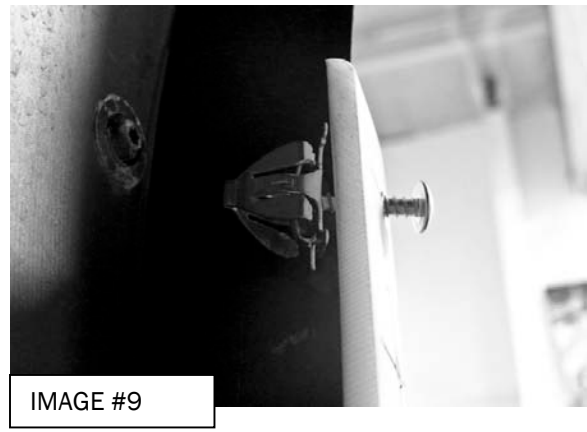
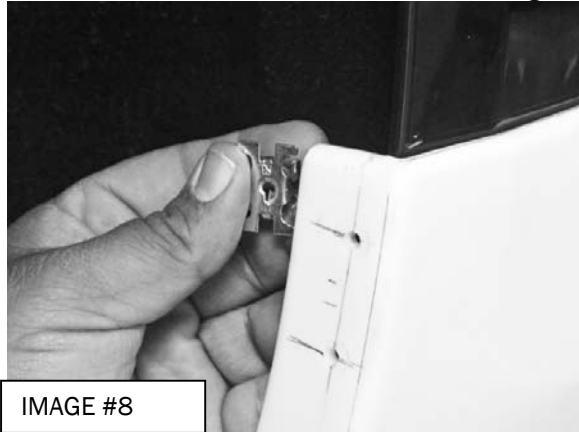

## SIDE SKIRTS

HARDWARE SUPPLIED	
8	#8 X 3/4" SELF DRILLING SCREWS
14'	3M TAPE

Step 1) Locate the (4) Factory T-25 screws in the front and rear wheel wells. Remove these screws, but do not discard. They will be used in the final installation. See image #10.

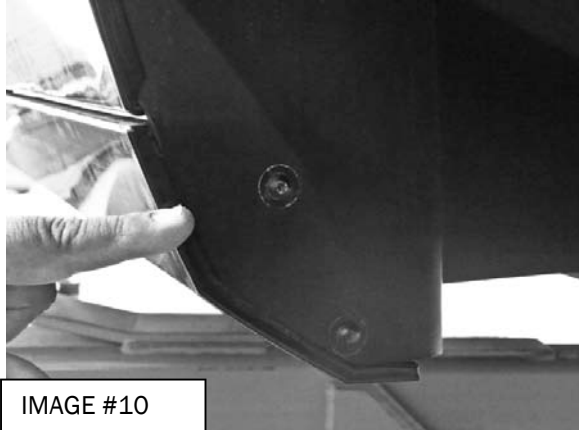

IMAGE #10

Step 2) Check fit of the Camaro side skirts on the car.

Step 3) Remove the part from the car and using lacquer thinner on a clean lint free cloth wipe the paint surface where the tape will attach. Using the 3M Primer 94 adhesion promoter supplied, apply the adhesion promoter to the paint surface where the tape will attach.

Step 4) Peel back a small piece of the red plastic backing from the tape making a tail that can be pulled when the side skirt is installed. Place the side skirt onto the vehicle. Starting with either end, pull the red backing tail and press the side skirt to the paint surface to insure good adhesion. See image #11.



IMAGE #11

Step 5) Using the factory screws previously removed in step 1, secure the side skirt in the front wheel well through the pre-drilled holes in the side skirt. See images #12-13.

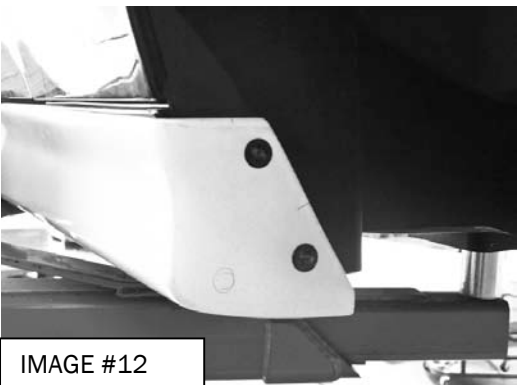

IMAGE #12

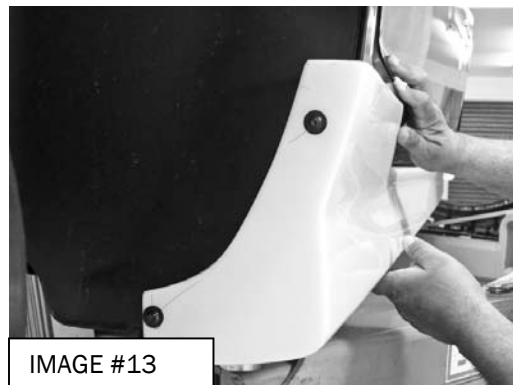

IMAGE #13

Step 7) Locate the (4) pre-drilled holes on the bottom of the side skirts and secure the side skirt to the bottom of the car with (4) #8 x 3/4" screws provided on each side. See image #14.



IMAGE #14

## REAR LOWER

HARDWARE SUPPLIED	
4	CRUZ CLIPS
4	1" PHILLIPS HEAD TRUSS SCREWS
5'	3M TAPE

Step 1) Locate and remove the 7mm factory screw in the factory rear lower. Do not discard. These will be used in the final installation. See image #15.



IMAGE #15

Step 2) Unclip the factory rear lower, as shown in image #16.



IMAGE #16



Step 3) Check fit the rear lower spat, ensuring at the tab fits in between the bumper and the factory rear lower. See image #17.



IMAGE #17

Step 4) Using a grease pencil draw a line around the top edge of the part, so that you have a reference to line the part up during the final installation. See image #18.

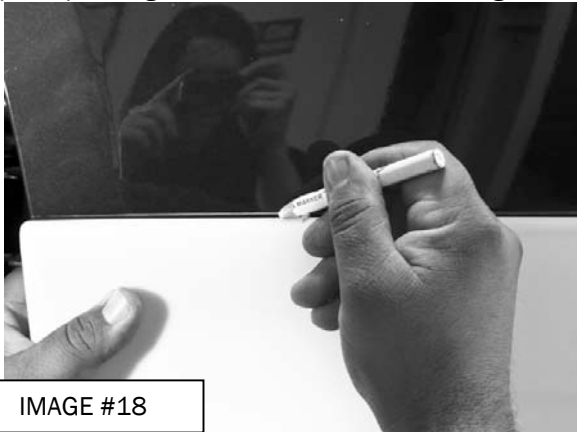

IMAGE #18

Step 5) Remove the part from the car. Using lacquer thinner on a clean cloth, wipe the paint surface where the tape will attach. Be careful not to remove the grease pencil marks. Using the adhesion promoter supplied, apply the adhesion promoter to the paint surface where the tape will attach.

Step 6) Peel back a small piece of the red plastic backing from the tape, making a tail that can be pulled when the rear lower is installed. Place the rear spat back onto the vehicle, positioning it using the grease pencil marks as a reference while ensuring that the tab fits in between the factory bumper and rear lower. Starting with the either side – right or left – pull the red plastic tail and press the rear lower to the paint surface to insure adhesion of the double face tape. See image #19.



IMAGE #19

Step 7) Using the (2) supplied cruz clips, secure the rear lower through the (2) pre-drilled holes in each wheel well. See images #20-21.

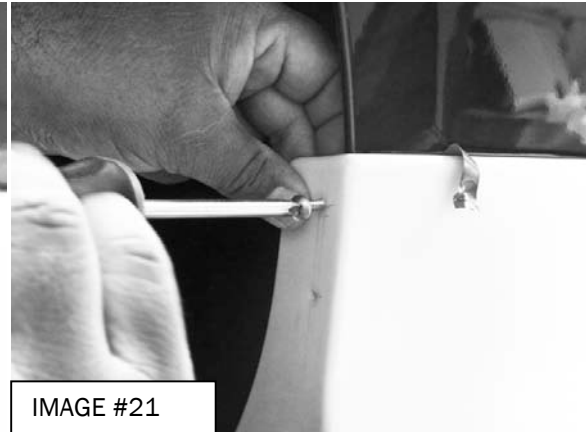
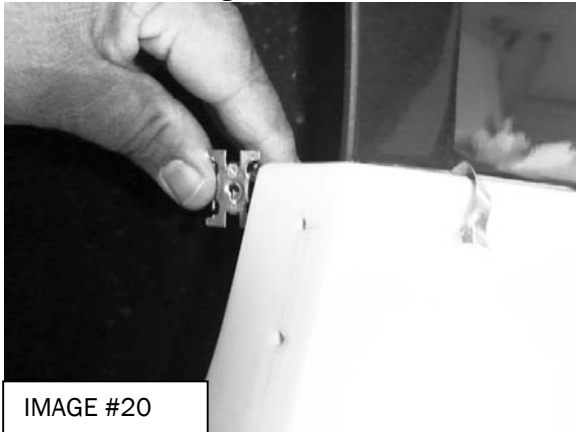

Step 8) Reinstall the factory screw, previously removed in step 1, through the pre-drilled hole on the 3dCarbon rear lower.