

STEP 3

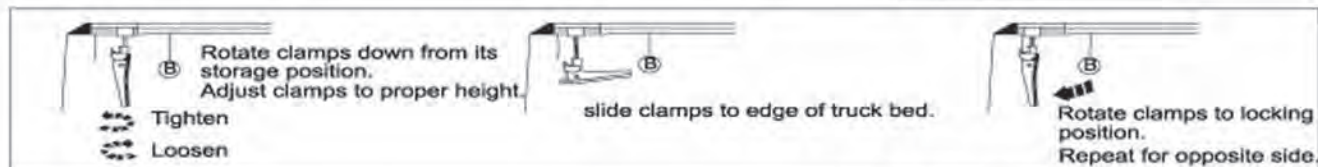
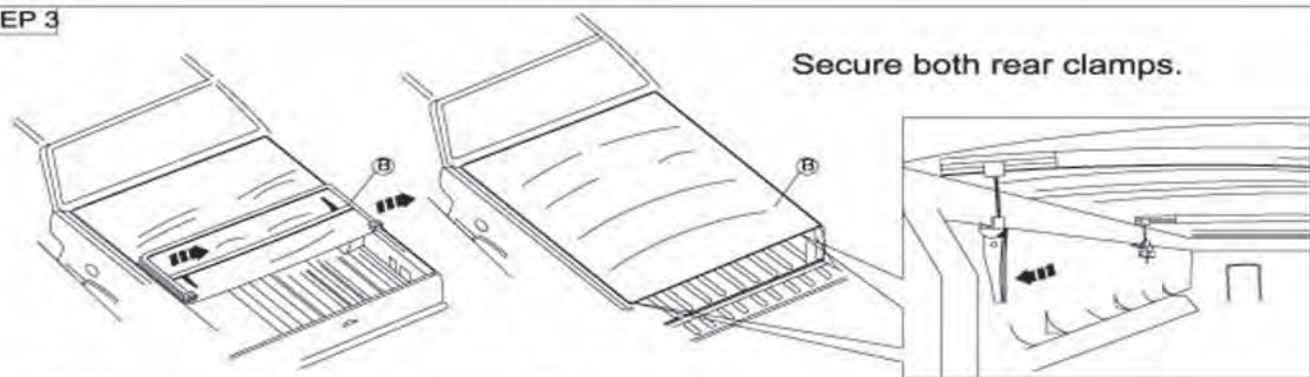

(Do not over tighten the clamps)

Warning: Prior to vehicle operation, clamps must be secured such that the clamps' lips tightly grip the inner bedwall structure.

To prolong the usage and function of tonneau covers, you should check it regularly for wear and looseness as well as other debris caught on the cover. Check mounting hardware regularly to insure that all clamping mechanism's tight and secured.

When cleaning your tonneau cover, make sure to clean your vehicle and cover in a shaded place like under a tree or in an open garage. Start by washing your lid with cool, clean water and a mild soap. Make sure to first flood the lid with water to remove surface grit that will scratch the finish when wiped. Next, using a hose, rinse the cover well making sure to remove all traces of soap and wipe off excess water using a sponge. Be careful to hose down the entire car to prevent soap from streaking your car's paint finish. Do not use chemicals like detergents, dish washing liquids, bleaches, harsh cleansers, strong cleaners, dry-cleaning solvents, or any other strong chemicals as a cleanser. Apply some quality vinyl cleaner that you can find in the nearest auto shop. Using a white all-cotton towel, wash the entire tonneau cover with the cleaner. Wash the entire tonneau cover and never spot clean to avoid rings or bright spots on your tonneau covers. Make sure that you will only use soft cotton cloth or sponge as a cleaning tool. Do not use rough abrasive cleaning pads because it can scratch the vinyl creating pores that allows dirt and other unwanted particles to stick.

DO NOT USE VINYL PROTECTANTS THAT CONTAIN PETROLEUM, SILICONE OR CITRUS BASED ADDITIVES TO INSURE YOUR COVER LOOKS IT'S BEST!