

PART#: 75-5094 / 75-5094D

Vehicle Application

YEAR: 2003 - 2007.5

MAKE: Dodge Ram

MODEL: 2500 / 3500

ENGINE: 5.9L Cummins

Note: This intake kit may not fit with the following Aftermarket Parts installed:

- Aftermarket Parts
- Body Lift or Lowering Kit
- Custom Hood
- Intercooler or Turbo Upgrades

Tools Required

- 8mm, 10mm, 13mm Wrench & Socket
- 1/2" Wrench & Socket
- T20 Torx
- 5/16" Nut Driver or Flat Blade Screwdriver
- Phillips Screwdriver, Pliers or Channel locks

Note: Approximate Install Time: 1 Hr 00 Mins.

S&B Filter Maintenance

KF-1035 Cotton Cleanable : If the enclosed filter is RED, it came pre-oiled from the factory. [Click here](#) for exact oil amount required for cleaning.

KF-1035D Dry Extendable : If the enclosed filters is WHITE, it is a disposable filter and should be discarded once it reaches capacity. This filter does not require oil.

Before You Start

- Please read the entire product guide before proceeding.
- Ensure all parts are present.
- If you are missing any of the components, call our customer support at (909) 947-0015.
- Do not work on your vehicle while the engine is hot.
- Make sure the engine is turned off and the vehicle is in Park or the Parking Brake is set.

Related Products

- Cotton Cleanable Filter (KF-1035)
- Dry Extendable Filter (KF-1035D)
- Cleaning & Oiling Kit (88-0008)
- Filter Wrap (WF-1023)
- Intake Scoop (AS-5049)
- Heater Block (76-1005)
- Intake Elbow (76-1004-1)

Air Box Plug Testing

Stock air boxes are a significant contributor to poor airflow which is why S&B designs custom air boxes with secondary and/or enlarged openings. With that said, S&B recognizes the benefits of cooler air. For optimal

Performance Testing

- After your installation is complete engage parking brake and start your engine. Listen for abnormal noises. If an air leak is detected, re-inspect hoses and connections as they may need to be repositioned and tightened

Warning!

If your vehicle has a Vehicle Emission Control Information decal affixed to the factory airbox, a new replacement label must be obtained and installed in a readily visible position in the engine compartment in order to remain CARB compliant. Failure to do so will prevent the vehicle from passing a smog check.

performance, we recommend that the intake be used without the end cap except in conditions of extreme heat.

- S&B FILTERS recommends that you keep your OE intake system in the event it is required in the future.
- In order to maintain your warranty, all connections and components must be checked periodically for alignment and for proper tension on all connections. Failure to do so may void your warranty.
- Use only S&B FILTERS cleaning and oil products to service your filter. Using any other brand oil and or cleaners on your S&B air filter may void your warranty.

Replacement labels can be ordered from your local dealership. Regulations state that the VECI label shall not be affixed to any equipment which is easily detached from the vehicle. Label placement, under the hood on a painted surface, is recommended.

Emission Standard

The California Air Resource Board (CARB) requires that an E.O. identification label be applied to the vehicle in order to pass a smog check inspection when a Performance Intake Kit has been installed. You must place the E.O. label provided on or near the intake kit after installation so that a smog check technician can easily verify the E.O. number. As of April 2009, S&B has never had a product where CARB denied an exemption request; however, the exemption process with CARB can take as long as 18 months. Check the status of the exemption process by looking up a specific part number at www.sbfilters.com. The CARB Exemption number and/or status is listed under the Product Details section for each part number. If the status shows as "Pending," CARB has yet to issue an exemption but the product has been submitted. Products that have not been issued an EO number are street legal in most states, but may not be used on emission controlled vehicles in the state of California and are for off-road use only. If you purchased your kit from S&B Filters directly, we will automatically mail you your Exemption Sticker when it is issued to us. If you purchased your kit from an authorized S&B Filters Dealer, log onto our web site and register to receive your Exemption Sticker.

EXPLODED VIEW

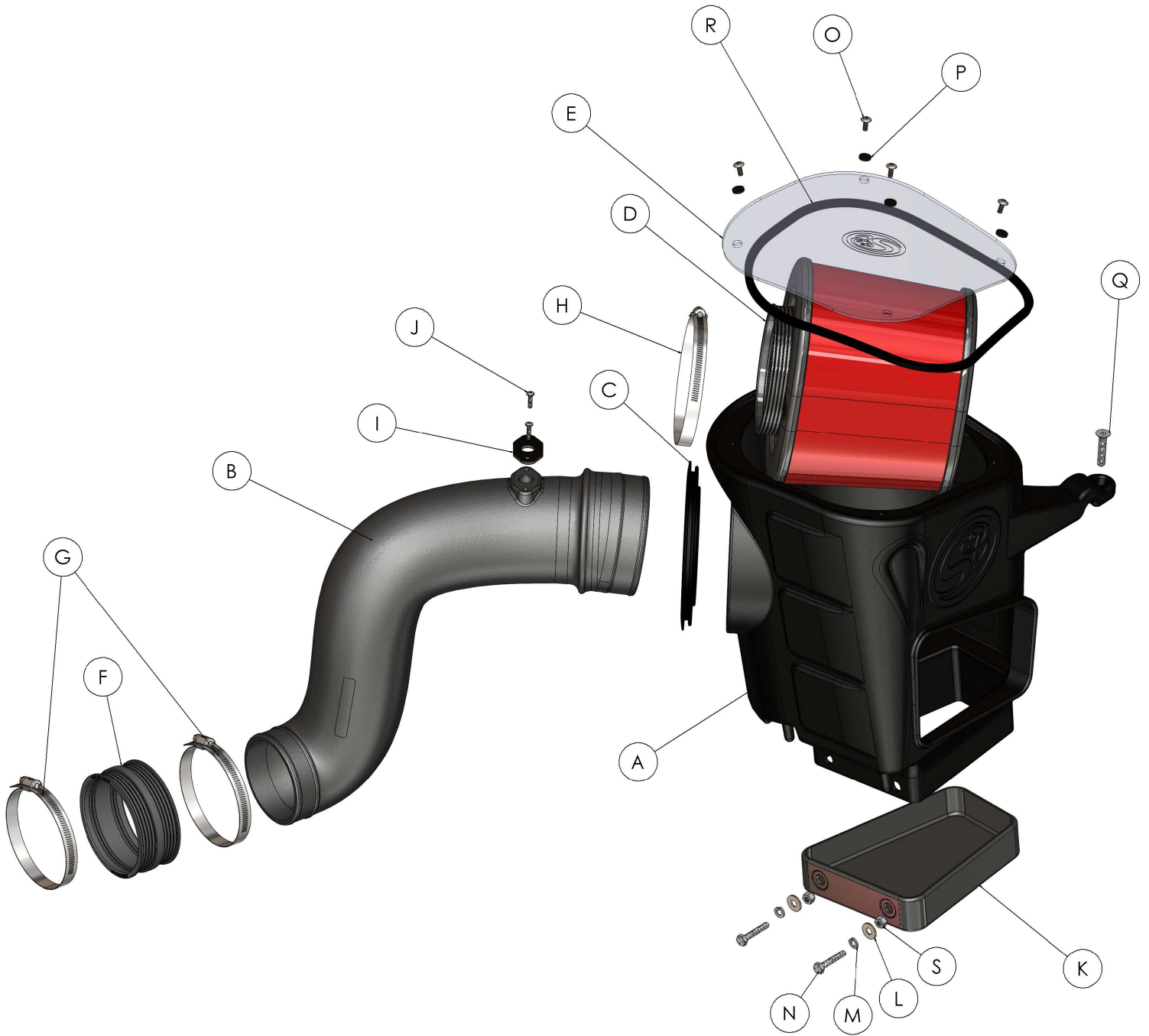

PARTS LIST

ITEM	QTY.	DESCRIPTION	P/N
A	1	AIR BOX	AL1272-00
B	1	INTAKE TUBE	AL1271-00
C	1	TUBE SEAL	AI1717C-00
D	1	AIR FILTER	KF-1035 or KF1035D
E	1	CLEAR LID	AI1613-00
F	1	SILICONE ADAPTER	AI1029C-00
G	2	HOSE CLAMP, #64	AG1018-00
H	1	HOSE CLAMP, #80	AG1010-00
I	1	IAT SENSOR GASKET	AI1344-00
J	2	SCREW, 8-32 x 5/8"	AI1434-00

ITEM	QTY.	DESCRIPTION	P/N
K	1	BOX PLUG	AL1207-00
L	4	WASHER, FLAT 1/4"	AI1073-00
M	2	WASHER, LOCK, 1/4"	AI1309-00
N	2	SCREW, HEX, 1/4-20 x 1-1/2"	AI1950-00
O	4	SCREW, TRUSS, 10-24 x 5/8"	AI1539-00
P	4	WASHER, SEALING, #10	AI1540-00
Q	1	SCREW, ALLEN, M8 x 1.25" x 40mm	AI1369-00
R	1	EDGE TRIM	AI1636-01
S	2	LOCKNUT, 1/4-20	AI1074-00

INSTALLATION STEPS

STEP 1

With the ignition switched off and the parking brake set, disconnect the negative battery cables on both batteries.

IMPORTANT: Failure to disconnect the battery for a minimum of 2 hours may cause the Check Engine Light to illuminate upon completion of the installation or subsequent operation. DO NOT SKIP THIS STEP!



STEP 2

Disconnect the electrical connection for the Intake Air Temp (IAT) Sensor, then unclip the wire loom from the tube.

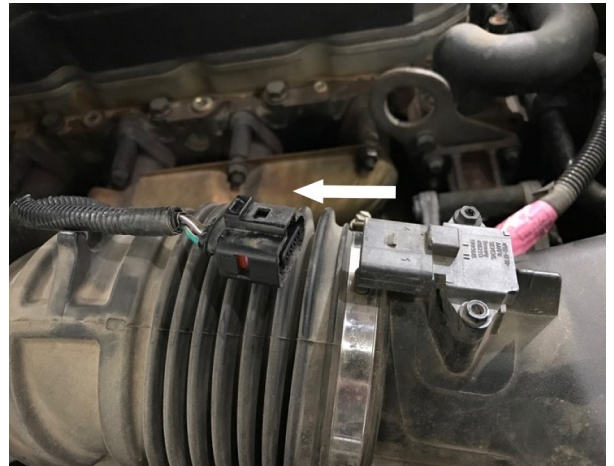

STEP 3

Loosen the hose clamp connecting the intake tube to the airbox lid then remove the mounting nut securing the stock airbox. Pull up on the stock airbox to remove it from the vehicle.



STEP 4

Loosen the hose clamp at the turbo inlet and then remove the intake tube from the vehicle.

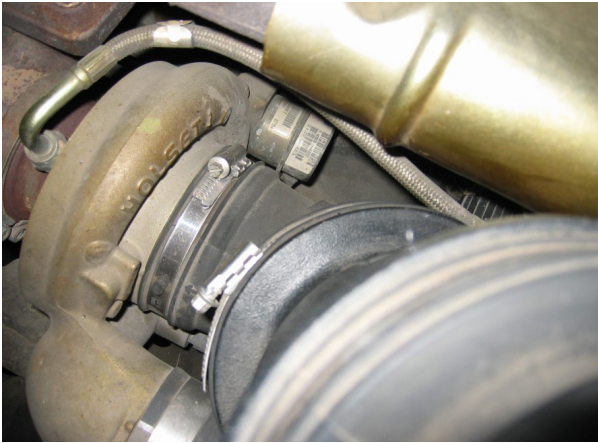

STEP 4 (IMAGE 2)



STEP 5

Install the Tube Seal (C) onto the AirBox (A).



STEP 6

(OPTIONAL) For those concerned about minimal engine heat; install the Box Plug (K) onto the bottom of the Airbox (A) using the provided 1/4-20 Screws (N), Lock Washers (M), Flat Washers (L) and Locknuts (S). For those seeking additional airflow, set the box plug aside.

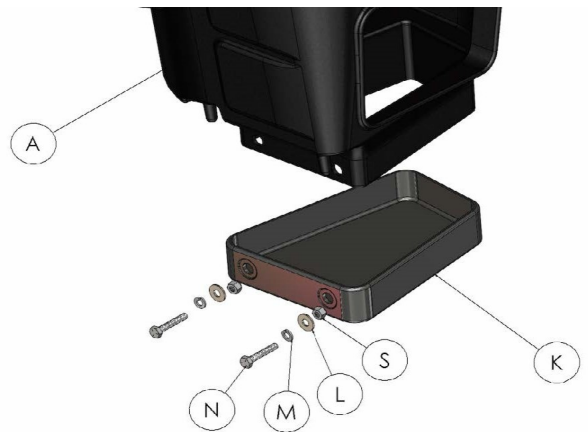

STEP 7

Carefully remove the IAT sensor from the stock airbox lid. Use the supplied 8-32 Screws (J) and IAT Gasket (I) to secure the sensor to the Intake Tube (B). Do not overtighten.



STEP 8

Slide the Silicone Adapter (F) and two #64 Hose Clamps (G) onto the Intake Tube (B). Make sure not to push the coupler too far deep into the tube. The edge of the coupler should meet up to the backstop bead and the edge of the tube should be about halfway through the coupler. Tighten the hose clamps on the intake side. Leave the other one loose for now.



STEP 9

Install the Intake Tube (B) onto the turbo. Do not tighten any hose clamps yet. Place the Air Filter (D) and Airbox (A) into the truck. Insert the other end of the air intake tube into the airbox. You may have to lift the air box up a little bit to get the air intake tube through the Tube Seal (C). The stop bead on the intake tube should be sealed up to the tube seal. Slide the air filter onto the intake tube and tighten the #88 Hose Clamp (H). Align the box prongs on the bottom of the airbox with the grommets on the side of the battery tray and push down on the box to completely seat the prongs onto the grommet. Tighten the hose clamp at the turbo.

STEP 9 (IMAGE 2)

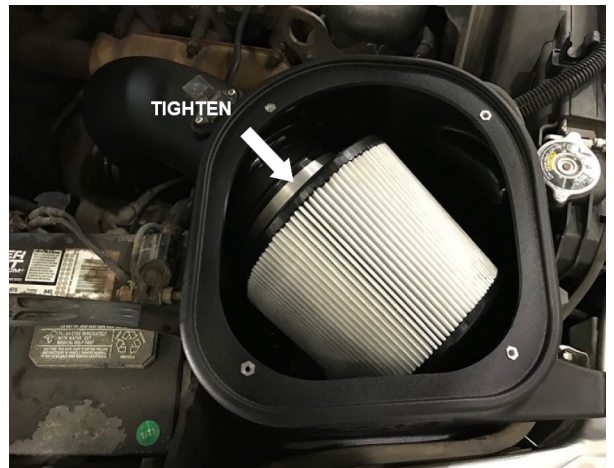
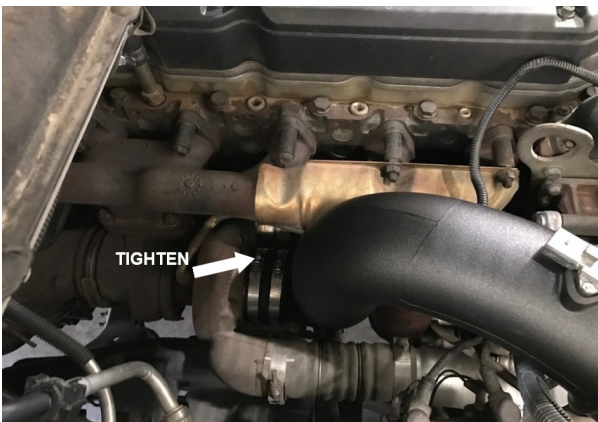

STEP 10

Secure the Airbox (A) using the stock mounting nut removed in Step #3.

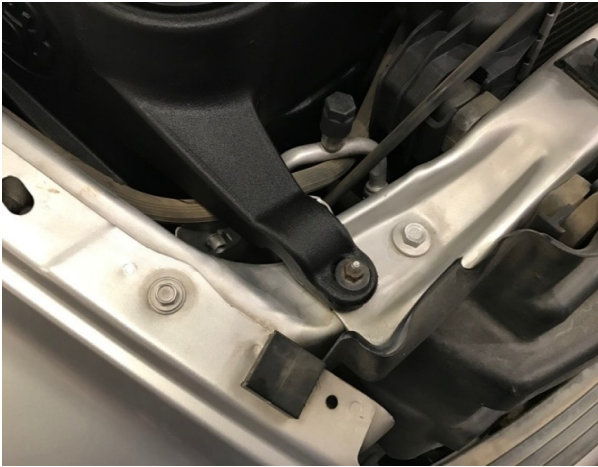

STEP 11

Remove the protective covering on the Clear Lid (E) and install the Edge Trim (R).



STEP 11 (IMAGE 2)



STEP 12

Place the Clear Lid (E) on top of the Airbox (A) using the supplied 10-24 Screws (O) and Washers (P).



STEP 13

Reconnect the electrical connector into the IAT sensor.



STEP 14

Reconnect the negative terminal on both batteries. Inspect your installation, make sure the kit is properly positioned and all fasteners are secure. Affix the CARB and ID label near the intake kit. The installation is now complete.

