

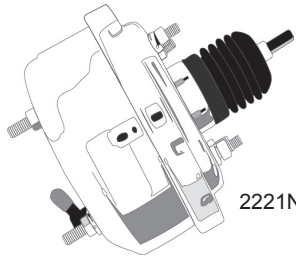

# Booster Dimensions

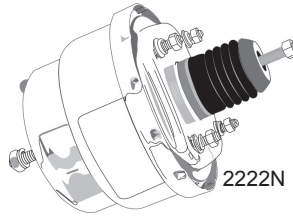

2221N



2222N

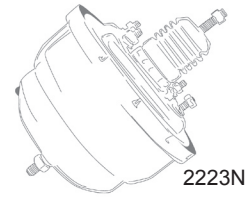

2223N

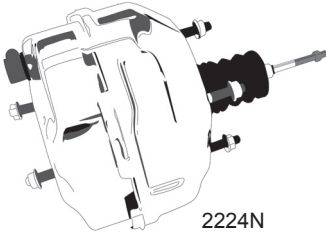

2224N

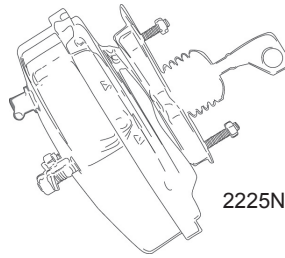

2225N

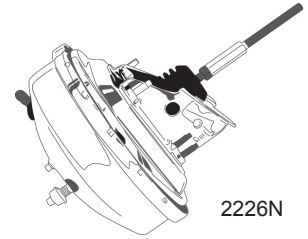

2226N

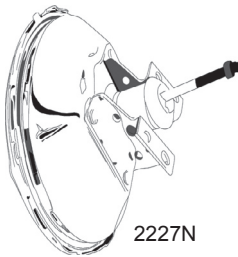

2227N

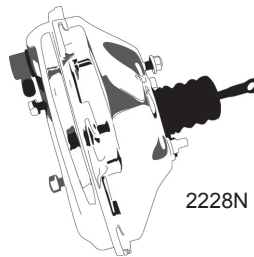

2228N

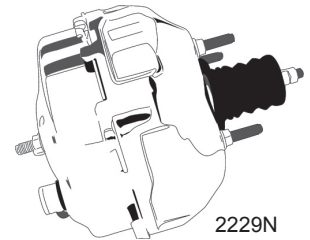

2229N

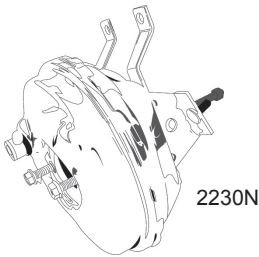

2230N

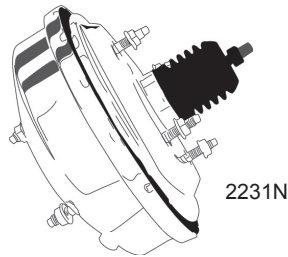

2231N

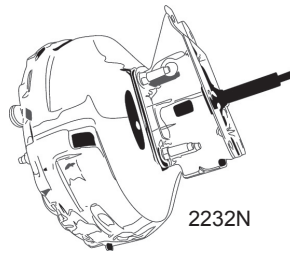

2232N

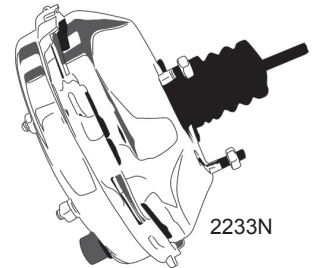

2233N

## POWER BRAKE BOOSTER DIMENSIONS

All boosters have a 3-3/8" square mounting footprint except 2225N, 2230N and 2233N.

Item	Description	Dia	Booster Rod		Mounting	Details
			Length	Length		
2221N	7" Single diaphragm	7"	3.50"	4.00"	4 studs	
2222N	7" Dual diaphragm	7"	5.25"	4.00"	4 studs	
2223N	8" Dual diaphragm	8"	5.25"	4.00"	4 studs	
2224N	9" Dual diaphragm	9"	6.00"	5.25"	4 studs	1-1/2" long studs
2225N	Ford Mustang 67-70, 9" single diaphragm	9"	3.75"	3.12"	4 studs	M6-1.0 x 1.25" offset studs
2226N	GM A & F body 64-66, 9" single diaphragm	9"	6.50"	1.50"	4 holes	1.5" past bracket
2227N	GM A & F body 66-72, 11" single, w/bracket	11"	6.50"	7.12"	4 holes	Angle booster bracket
2228N	11" Single diaphragm w/studs	11"	4.25"	4.62"	4 studs	4.62" mounting surface to center of eyelet
2229N	Corvette 68-82, 9" dual diaphragm	9"	6.00"	4.12"	4 studs	1-1/2" long studs
2230N	Corvette 63-67, 9" single diaphragm	9"	6.25"	3.12"	2 studs	With bracket
2231N	9" Single diaphragm Slim line	9"	4.00"	3.81"	4 studs	
2232N	GM Truck 73-92, 11" dual diaphragm	11"	8.50"	3.25"	4 holes	1-1/2" long studs
2233N	Nova 62-67, 9" single diaphragm	9"	4.25"	5.25"	3 studs	



# Booster /Master Dimensions



2121N



2122N

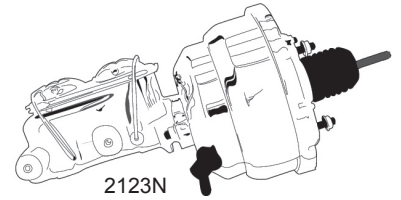

2123N

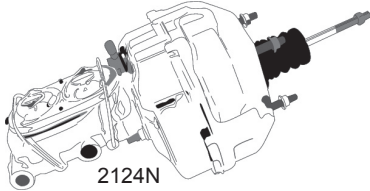

2124N

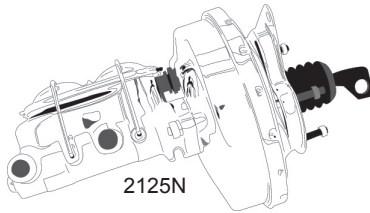

2125N

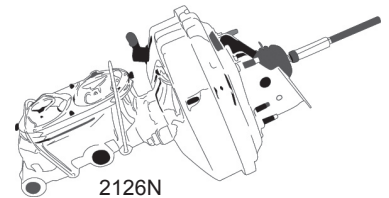

2126N

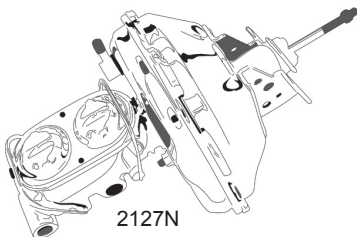

2127N

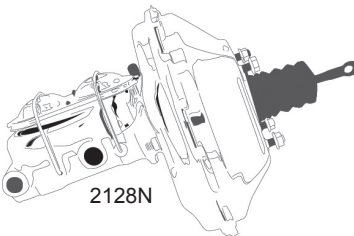

2128N

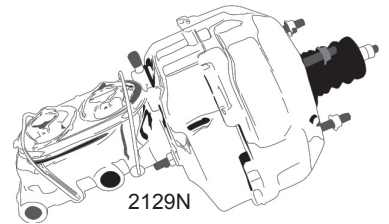

2129N

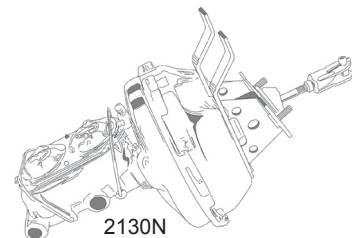

2130N

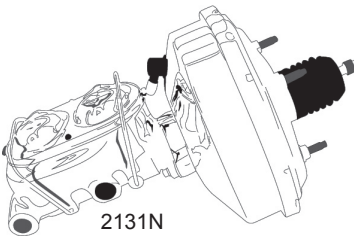

2131N

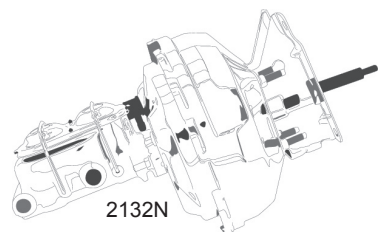

2132N

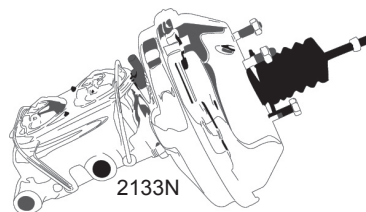

2133N

**TECH TIP**  
All 4-stud booster and combo mounts feature a 3-3/8" square centerline mounting pattern

## BOOSTER / MASTER COMBO DIMENSIONS

### Universal master cylinder w/power brake booster combo

Item	Description	Dia	MC		Booster Rod		Mounting Details
			Length	Length	Length	Length	
2121N	7" Single diaphragm combo	7"	8.00"	3.50"	4.00"	4 studs	
2122N	7" Dual diaphragm combo	7"	8.00"	5.25"	4.00"	4 studs	M8-1.5 metric studs
2123N	8" Dual diaphragm combo	8"	8.00"	5.25"	4.00"	4 studs	3/4" long studs
2124N	9" Dual diaphragm combo	9"	8.00"	6.00"	5.25"	4 studs	M10-1.5 x 1-1/2" long studs
2128N	11" Single w/studs diaphragm combo	11"	8.00"	4.25"	4.62"	4 studs	4.62" from mtg surface to center of eyelet
2131N	9" Single diaphragm Slim line w/studs combo	9"	8.00"	4.00"	3.81"	4 studs	

### Dedicated master cylinder w/power brake booster combo

2125N	Mustang 67-70, 9" single diaphragm w/bracket combo	9"	7.50"	3.75"	3.12"	4 studs	Offset studs
2126N	GM A & F body 64-66, 9" single diaphragm w/bracket combo	9"	8.00"	6.50"	1.50"	4 holes	1.5" past bracket
2127N	GM A & F body 66-72, 11" single diaphragm w/bracket combo	11"	8.00"	6.50"	7.12"	4 holes	Angle booster bracket
2129N	Corvette 68-82, 9" dual diaphragm	9"	8.00"	6.00"	4.12"	4 studs	1-1/2" long studs
2130N	Corvette 63-67, 9" single diaphragm w/bracket combo	9"	8.00"	6.25"	3.12"	bracket	With 2 studs
2132N	GM Truck 73-92, 11" dual diaphragm, 1-1/2" long studs	11"	8.00"	8.50"	3.25"	4 holes	Angled from 2.75" at top to 3.0" at bottom
2133N	Nova 62-67, 9" single diaphragm combo	9"	8.00"	4.25"	3.25"	4 holes	